

**CEC**  
 CIVIL ENGINEERING CONSULTANTS  
 DON DURDEN, INC.  
 11550 I.H. 10 WEST, SUITE 395  
 SAN ANTONIO, TEXAS 78230  
 P) 210.641.9999  
 F) 210.641.6440  
 Website: www.cectexas.com  
 T.B.P.E. REGISTRATION NO. F-2214

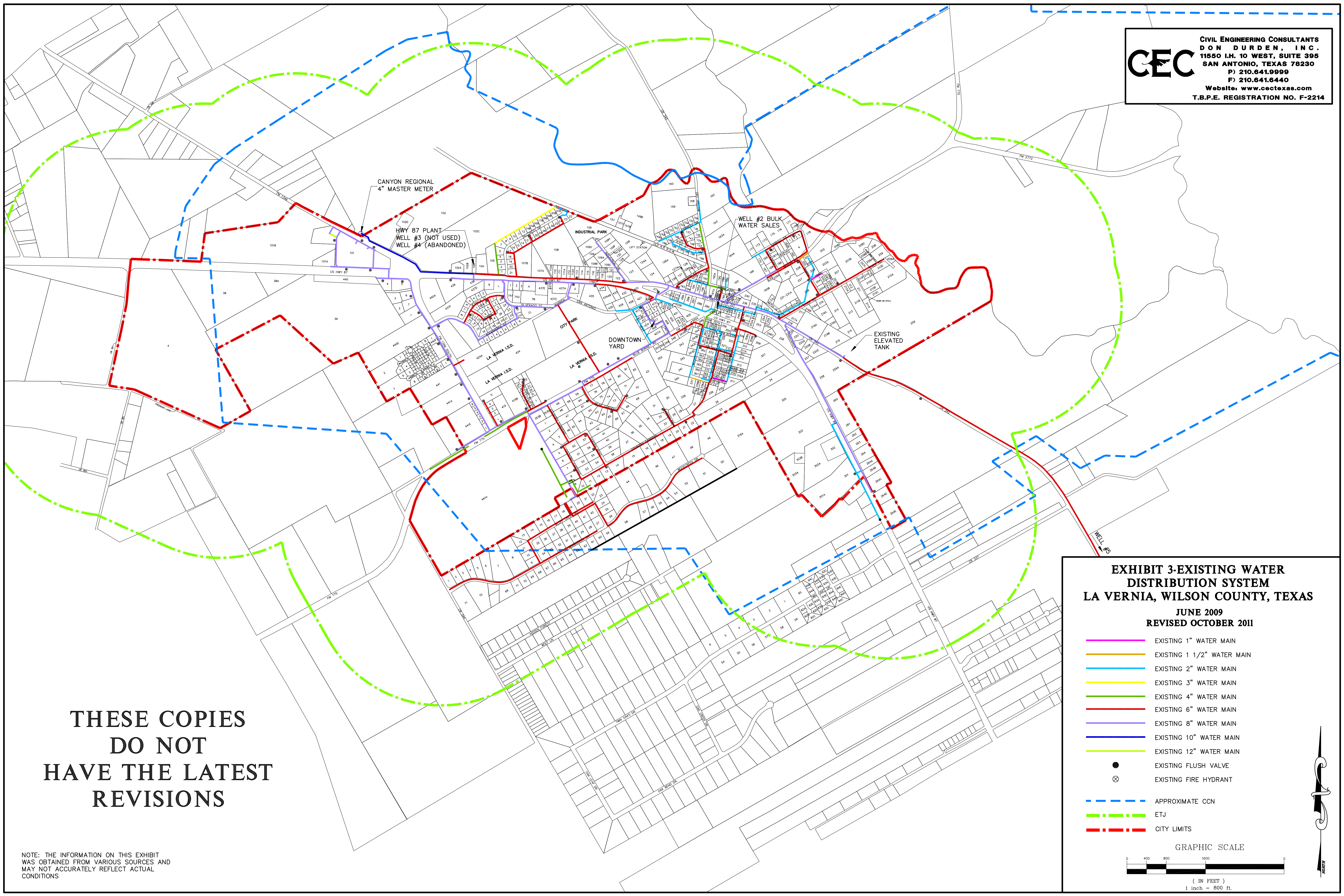

**EXHIBIT 3-EXISTING WATER DISTRIBUTION SYSTEM  
 LA VERNIA, WILSON COUNTY, TEXAS**

**JUNE 2009  
 REVISED OCTOBER 2011**

- EXISTING 1" WATER MAIN
- EXISTING 1 1/2" WATER MAIN
- EXISTING 2" WATER MAIN
- EXISTING 3" WATER MAIN
- EXISTING 4" WATER MAIN
- EXISTING 6" WATER MAIN
- EXISTING 8" WATER MAIN
- EXISTING 10" WATER MAIN
- EXISTING 12" WATER MAIN
- EXISTING FLUSH VALVE
- ⊗ EXISTING FIRE HYDRANT
- - - APPROXIMATE CCN
- - - ETJ
- - - CITY LIMITS

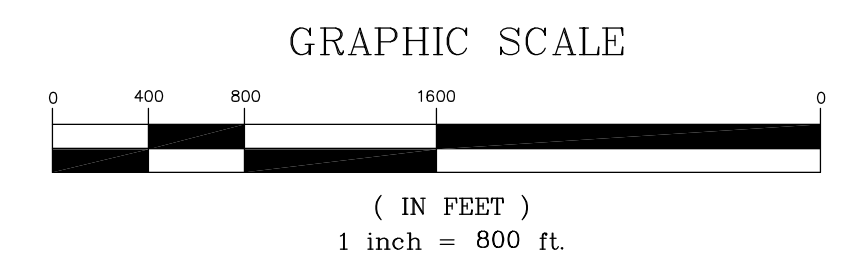

**THESE COPIES  
 DO NOT  
 HAVE THE LATEST  
 REVISIONS**

NOTE: THE INFORMATION ON THIS EXHIBIT WAS OBTAINED FROM VARIOUS SOURCES AND MAY NOT ACCURATELY REFLECT ACTUAL CONDITIONS

